

CorkSport Mazdaspeed 6 Mud Flaps

2006-2007 Mazdaspeed 6



The **CorkSport Mazdaspeed 6 Mud Flaps** are made from the finest quality urethane material, our mud flaps are designed not to tear, peel, fade, rust or break and will provide protection for your Mazdaspeed 6 against the elements, road debris, and high impact rocks that are kicked-up by your tires. Please let us know your feedback by submitting a review at: <http://www.corksport.com/corksport-mazda-mud-flap-set-mazdaspeed-6.html>

Pre-Installation Notes:



These instructions were written for reference only and the use of a factory service manual is recommended. Please read these instructions thoroughly prior to starting installation



How our instructions work: To best cover all of our customers experience levels, we have included an overview checklist for the more technically advanced users along with step-by-step instructions for customers that require additional detail.



These installation instructions are for use with a **2006-2007 Mazdaspeed 6**. If you have a different vehicle, contact us for the appropriate instructions for your application.

Materials and Time:



General Info.

Part #: Ate-8-900

Time Est: 45-60 min

Wrench Rating: 1/5



Tooling List

Phillips Screw Driver

10mm Wrench

¼" Drill Bit

Drill



Parts List

Corksport Mazdaspeed 6 Mud Flaps

8x M6 Flange Bolts

2x M6 Bolt

12x M6 Flange Nut

12x M6 Washers

4x Expanding Fittings

Need Help With Your Installation?

Call (360) 260-CORK

Checklist

This is an overview of each step in the build. You can use this as a reference and a checklist as you button up the work on your car

1. Installing the Front Mud Flaps

- 1a)** Before beginning the installation determine if the length is correct for your ride height. Trim using template if desired.
- 1b)** Support the car on jack stands and remove the front wheels for better access.
- 1c)** Remove the screw and snap fittings holding the fender liner. (circled in red in Figure 1a)
- 1d)** Using the factory screw, mount the mud flaps using the top hole (yellow circle in Figure 1b)
- 1e)** Using a supplied Flange bolt, nut and washer, reach behind the side skirt and attach mud flap (blue hole shown in Figure 1b)
- 1f)** Drill hole into fender liner through green hole in Figure 1a and Figure 1b with ¼" drill bit, use snap fitting to secure.
- 1g)** Use snap fitting to secure remaining hole.
- 1h)** Once desired look is achieved tighten hardware to secure mud flap.

2. Installing the Rear Mud Flaps

- 2a)** Hold mud flap against back of rear fender. Position until desired height & location is reached.
- 2b)** Using a sharpie mark fender to locate mounting holes (Figure 2a).
- 2c)** Support rear of car on jack stands and remove wheels.
- 2d)** Using a ¼" drill bit, drill through the rear bumper, fender, and fender liner.
- 2e)** To space inside hole away from fender liner use this stack up: Bolt, Washer, Mud Flap, Nut, Washer, Fender Liner, Washer, Nut (shown in Figure 2c).
- 2f)** Use flange bolts, washer, and flange nuts to attach the rear mud flap to the bumper and fender.
- 2g)** Adjust laterally and once desired look is achieved tighten bolts to secure mud flap.

Detailed Instructions

1. Install Front Mazdaspeed 6 Mud Flaps

1a) Before installing, hold one of the front mud flaps up to the vehicle. Line up the holes in the mud flap to the snap fittings used for mounting. Depending on your ride height you may determine the length is too long. If they are too long, measure how much needs to be trimmed. Use the template included in the instructions to mark the outline of the bottom edge of the mud flap. Use a sharp utility knife to trim the mud flap to your desired length. Take your time as you only have one shot at this step.

NOTE Note: The closer the mud flaps are to the ground, the more protection your vehicles paint will have from road debris.

1b) Place the front of the vehicle on jack stands and remove the front wheels.

1c) Remove the screw and snap fittings holding the fender liner (circled in red in Figure 1a).

1d) Using the factory screw, mount the mud flap using the top hole (yellow circle in Figure 1b).



Figure 1a



Figure 1b

1e) Using a supplied Flange bolt and nut, mount through the bottom hole of the mud flap (blue circle in Figure 1b). Insert the bolt through and reach behind the side skirt to thread on washer and nut. It is a tight fit so the easiest approach is to hold the nut against the side skirt and locate the hole. Then feed the bolt through and tighten by hand.

1f) Drill a hole into the fender liner through green hole in Figure 1a and Figure 1b with ¼" drill bit. Use a provided snap fitting to secure. Push the snap fitting through and then depress the head of the screw to tighten.

1g) Use a snap fitting to secure the remaining hole (red circle in Figure 1b).

1h) Once desired position is achieved tighten hardware to secure mud flap, and repeat for the other side.

2. Installing the Rear Mud Flaps

- 2a) Hold the mud flap against back of the rear fender. Position the mud flap to your desired height and location.
- 2b) Using a marker, mark the fender to locate the mounting holes as shown in **Figure 2a**.
- 2c) Support rear of car on jack stands and remove the rear wheels.
- 2d) Using a ¼" drill bit, drill through the rear bumper, fender, and fender liner for all of the mounting locations.
- 2e) To space the inside hole (circled in **green** in **Figure 2b**) away from fender liner use the bolt stack up shown in **Figure 2c**: Bolt, Washer, Mud Flap, Nut, Washer, Fender Liner, Washer, Nut.
- 2f) In the remaining holes (circled in **red** in **Figure 2b**) use flange bolts, washer, and flange nuts to attach the rear mud flap to the bumper and fender. Use the washer on the nut side.
- 2g) Adjust the mud flaps side to side and once your desired look is achieved tighten the bolts to secure mud flap. Repeat for the other side.



Figure 2a



Figure 2b

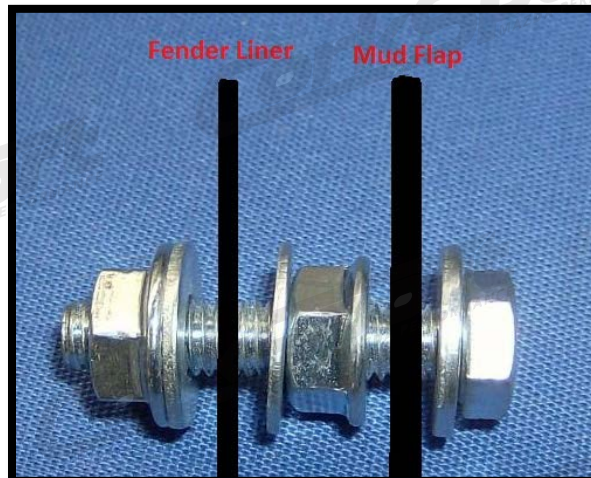

Figure 2c

Need Help With Your Installation?
Call (360) 260-CORK



This completes the installation of your Mazdaspeed 6 Mud Flaps. Take your vehicle for a test drive. If the mud flaps are scraping on the ground, trim them shorter; or if they don't seem to protect the sides of your car well, adjust them outwards. Double check that they are secure. Check out our [knowledgebase](#) for additional install information.

What's Next:

[CorkSport Stub Antenna](#)



Eliminate your oversized factory rubber antenna and enhance the look of your Mazda with a CorkSport low profile antenna. CorkSport's 2.75" stub antenna, made for some 2006-2007 Mazdaspeed 6's, is made from billet aluminum and has a long lasting, durable finish. Designed to easily replace the OEM antenna, the CorkSport antenna takes mere minutes to install and is made to fit the genuine Mazda antenna base.

Please note: This is only available for Mazdaspeed 6's that have an external antenna. Please check the style of antenna on your car prior to purchasing <http://www.corksport.com/corksport-mazda-stub-antenna.html>

[CorkSport DRL Light Kit](#)

An alternative to HID's, these LED lights are designed for use in your factory fog light housings and output a color temp in the 6,000k range that is perfect for matching existing or future HID headlights. The kit includes 2 bulbs, each with 23 LED's and requires no tools for plug and play installation. These lights last longer than the factory incandescent bulbs and draw less power.

<http://www.corksport.com/corksport-led-drl-kit-h11.html>

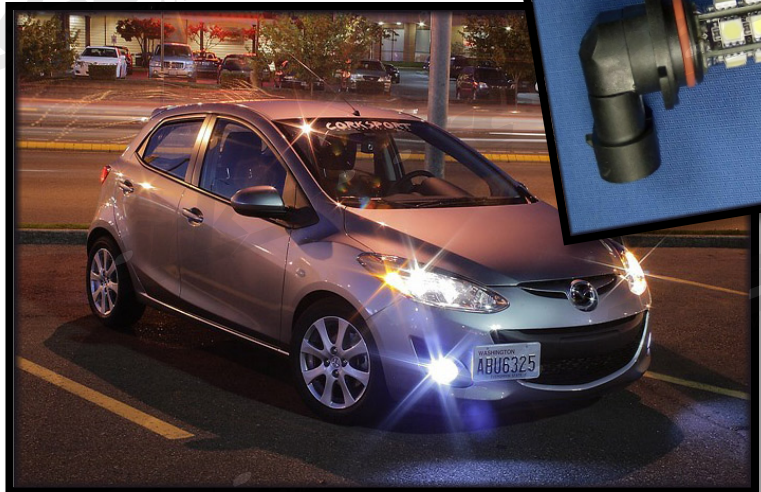

Front Mud Flap Cutting Template

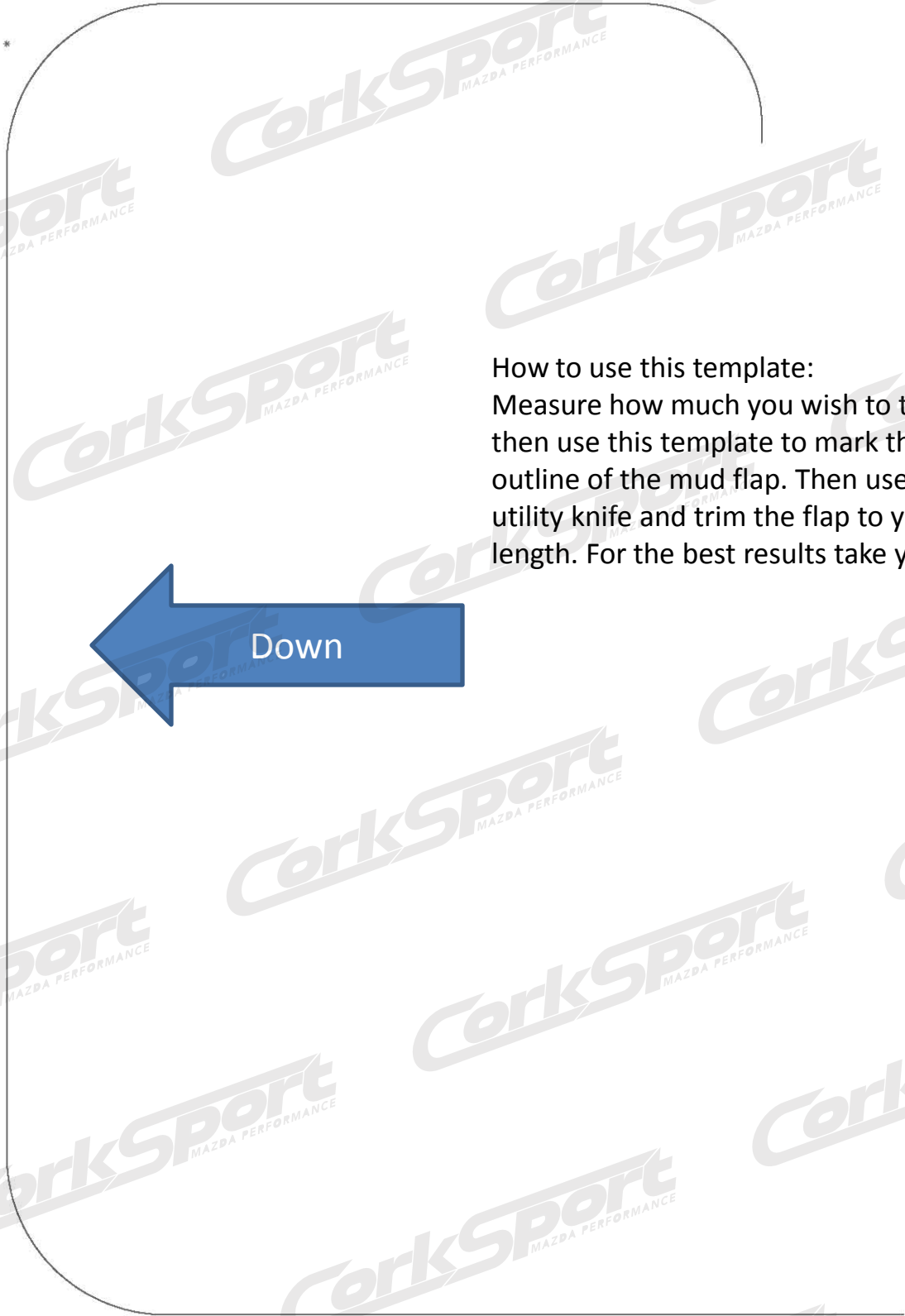

How to use this template:
Measure how much you wish to trim off, then use this template to mark the bottom outline of the mud flap. Then use a sharp utility knife and trim the flap to your desired length. For the best results take your time.